

DATA SOURCES

NJ DEPARTMENT OF ENVIRONMENTAL PROTECTION (NJDEP)
 - Environmentally Sensitive Areas
 - Streams & Surface Water (Hydrology)

SOMERSET COUNTY ENTERPRISE
 - Municipal Boundaries
 - County-owned Open Space
 - Highways, County & Local Roads
 - Railroads

SOMERSET COUNTY PLANNING DIVISION
 - Preserved Lands

MUNICIPAL DATA
 - Adopted Master Plans, Green Acres Program Information, Municipal GIS Open Space Data, and Other Information Provided by Municipality

NOTES

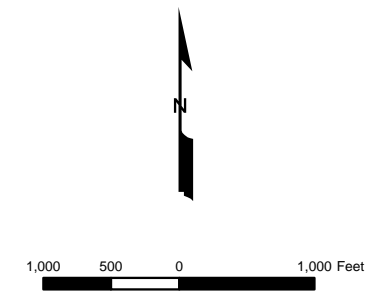

1. The preserved lands shown on this map represent the best GIS information available at the current time. This data is a required component of the Wastewater Management Plan (WMP) Build-out and Capacity Analysis.

2. Somerset County uses the following map projections & coordinate system when presenting GIS data:
 - Horizontal: North American Datum 1983 (NAD83)
 - Vertical: North American Vertical Datum 1987 (NAVD87)
 - Coordinate System: New Jersey State Plane Feet

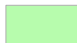

Legend

LAND PRESERVATION TYPE:

-  **State Preserved Lands**
 (parkland, wetland mitigation areas, flood control areas, and other undevelopable state-owned lands)
-  **County Preserved Lands**
 (parkland, public golf courses, greenways, and other undevelopable county-owned lands)
-  **Local Preserved Lands**
 (municipal parkland, homeowner association common areas, stormwater management facilities, non-profit and private deed-restricted lands, and other undevelopable local lands)

 **ENVIRONMENTALLY SENSITIVE AREAS**

 **STREAMS & SURFACE WATER**

 **MUNICIPAL BOUNDARIES**

MAJOR ROADS
 **US Highway 22**
 **County Roads**
 **Local Streets**

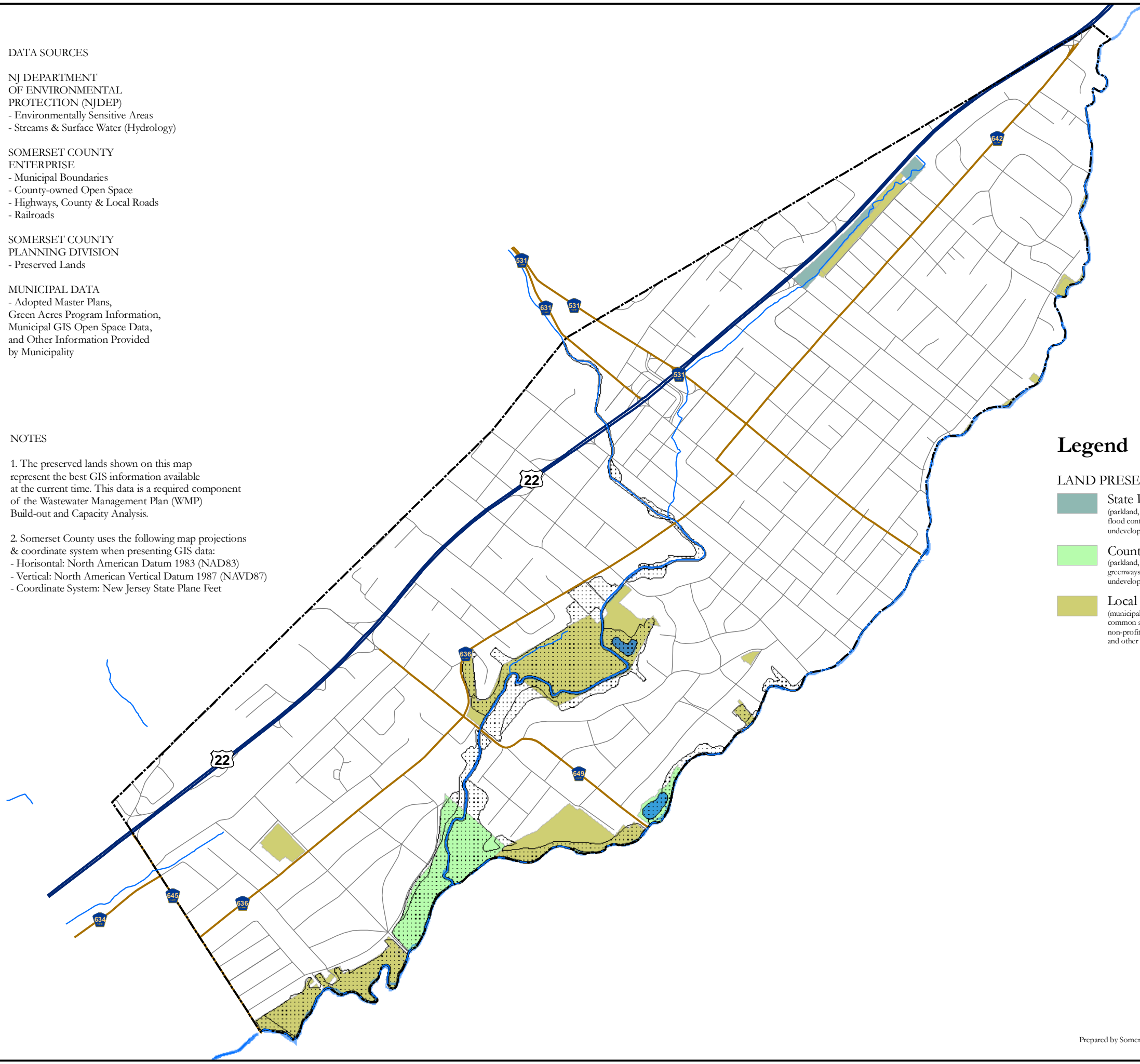

NORTH PLAINFIELD BOROUGH
 Somerset County, NJ

Map V

PRESERVED LAND